

Version MISC.00#BLF

Collection Taps

TECHNICAL FEATURES

Materials/Finishes Painted black

Function Extracting/Filtering

Cut-out Cut-out diameter 35 mm

Dimensions Single-lever sink mixer with swivel spout and retractable hand shower 3/8" female connection hoses cm

Notes

WEIGHTS AND VOLUMES

Gross weight 2.8 kg

Net weight 2.5 kg

Volume 0.01 m3

Packaging dimensions L 485 x H 90 x P 250 mm



Photograph is for information purposes only. May not correspond to the selected version

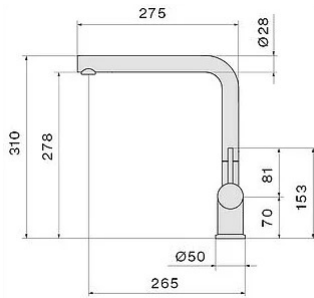

FLOW RATE / PRESSURE